

Rev.	Description	Date	Drawn	Checked
A	INITIAL RELEASE	2005.10.10	SHC	

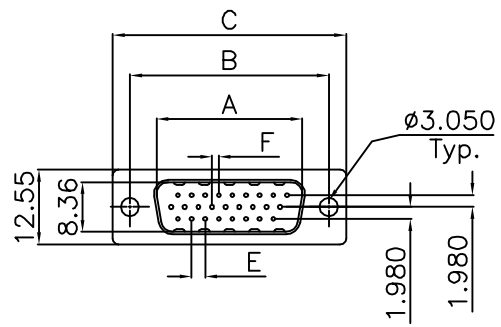

Notes:

1.ELECTRICAL CHARACTERISTICS

Contact Current Rating:3Amperes.
 Dielectric Withstanding Voltage:AC 500V at sea level.
 Insulation Resistance:1000 Megohms Min.
 Operation Temperature : -55°C to +105°C.

2.Material

Insulator: Option (PBT/PA6T /LCP /PA9T)
 Shell: SPCC.
 Screw: Copper Alloy.

3.PART NO.:

102XXMX3-X-X-X-LF

Series: D-Sub Comrip Typ

Pin No.: 15, 26, 44, 62

Male

Shell Plated:
 7.Full Nickel
 8.Nickel /But back-Shell:Tin.
 9.Tin
 11.Gold

Color Type:
 3 Black

Insulator Material:
 Vacant:Default PBT
 P2:PA6T
 P3:LCP
 P4:PA9T

Screw Size:
 Vacant:No Screw
 S:4.8
 M:5.0
 L:5.8

Screw Type:
 Vacant: No Accessories
 A After -Screw H=3.0
 B After -Screw H=4.0
 C After -Screw H=5.8
 D Before -Screw H=5.8
 E .Coalescent Nut H=5.8

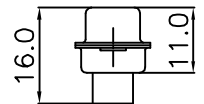
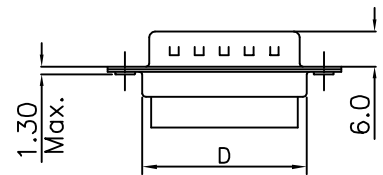

S	4.8
M	5.0
L	5.8

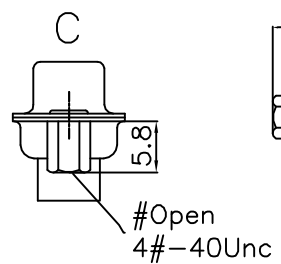
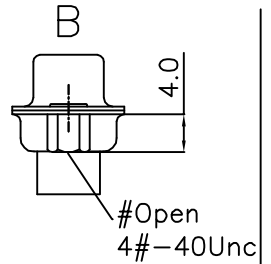
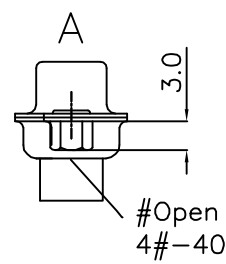

No.	A	B	C	D	E	F
15	16.33	24.99	30.81	19.23	2.29	1.145
26	24.66	33.32	39.14	27.56	2.29	1.145
44	38.38	47.04	53.04	41.28	2.29	1.145
62	54.84	63.50	69.32	57.33	2.41	1.205

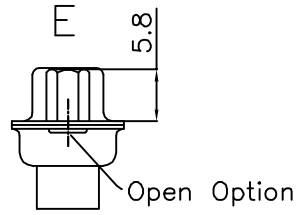
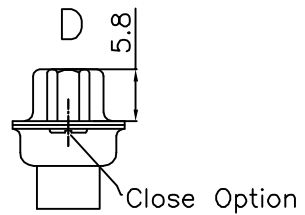

GENERAL TOLERANCE: .X ±0.30 Ang. ±2° .XX ±0.25 .XXX ±0.15	SCALE: Free	DATE: 2005.10.10	慶崙企業股份有限公司 CHINSHONG ENTERPRISE CO.,LTD.
	UNIT: mm	PROJECTION:	
DWG. No.	TITLE: D-SUB H-D Male Crimp	PART No.:	102XXMX3-X-X-X-LF