

RevNo	Item	Date	Signature	Checked
X1	modification screw type	2012-02-15	Eric_Lin	
X2	Add Option	2012-06-28	Eric_Lin	
X3/X4	Add Option	2012-07-09	Eric_Lin	

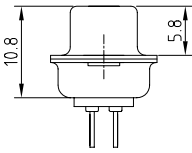
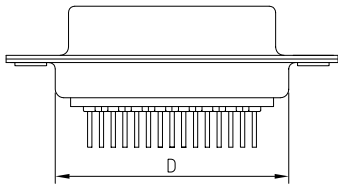
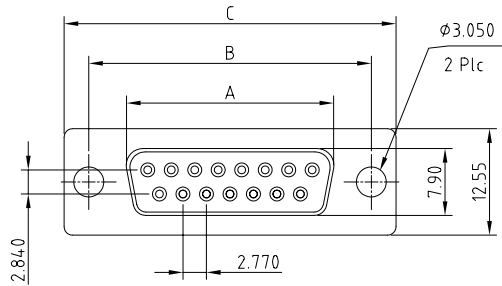

1 0 7 X X F X X X - - - - L F

D-Sub 180D	Vacant:Default PBT
09	P2:PA6T
15	P3:LCP
25	P4:PA9T
37	Vacant: No Screw
Female	M: 5.0x10.0 X1
7.Full Nickel	L:5.8x10.8
8.Nickel /But Back-Shell:Tim.	Vacant: No Accessories
9.Tin	A. After -Screw H=3.0
11.Gold /But Back-Shell:Tim	B. After -Screw H=4.0
	E. Coalescent Nut H=5.8
	E1. Coalescent Nut H=4.0 X2
	G. After -H=6.1
	H. After -H=6.1, And Before H=5.3
	H1. After -H=6.1, And Before H=6.1 X3
	Blank. 1u'
	3. 3u' X4
	7. 15u'
	8. 30u'
	1. Full Gold
	2. Half Gold

Recommend Layout PCB.

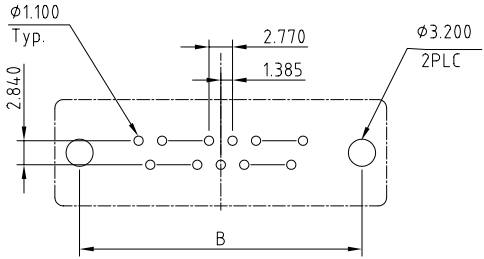

Note:

No.	A	B	C	D
09	16.33	24.99	30.81	19.23
15	24.66	33.32	39.14	27.56
25	38.38	47.04	53.04	41.28
37	54.84	63.50	69.32	57.33

ELECTRICAL CHARACTERISTICS

Contact Current Rating:3Amperes.
 Dielectric Withstanding Voltage:AC 500V at sea level.
 Insulation Resistance:1000Megohms Min.
 Contact Resistance:30Milliohms Max.
 Operation Temperature : -55°C to +105°C.

Material

Contact :Copper Alloy.
 Insulator:PBT. (Select PA6T /LCP /PA9T)
 Shell: SPCC.
 Screw: Copper Alloy.

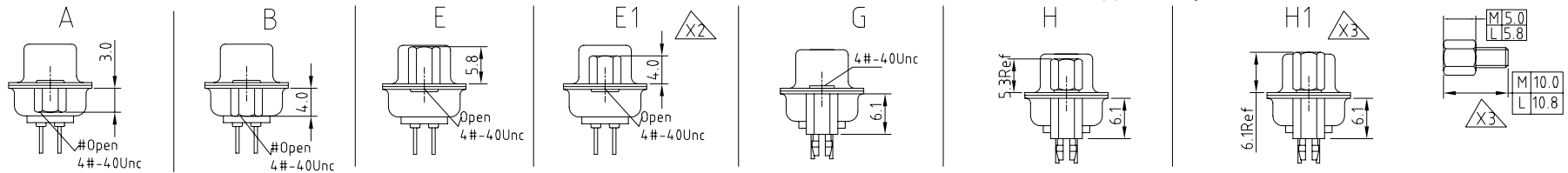

DRAW.BY	Eric_Lin	DATE	2005-10-10	UNIT	MM	TOLERANCE	X ±0.30 XX ±0.25 XXX ±0.150	Ang. ±2°	Chin Shong Enterprise CO., LTD.	ITEM	D-SUB Female 180D- DIP
APPVL.BY		VERSION	A	SCALE		DWG.No.	F:/XX/ / +			PART No.	
										CUSTOMER	