

1 2 3 4 5 6 7 8

RevNo		Date	Signature	Checked

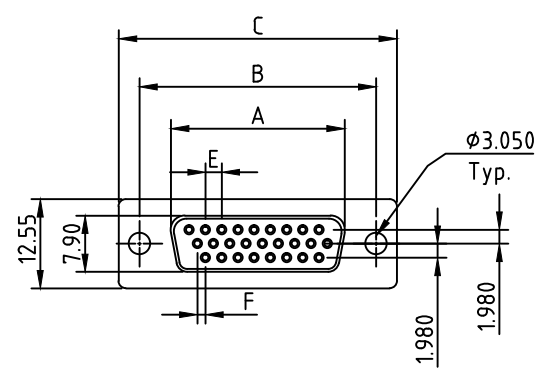

1 0 6 X X F X X X - - - - L F

D-Sub Solder Typ	15	26	44	62	Female	Vacant:Default PBT	P2:PA6T	P3:LCP	P4:PA9T	Vacant:No Screw	S:4.8	M:5.0	L:5.8
7.Full Nickel						Vacant:No Accessories	A After -Screw H=3.0	B After -Screw H=4.0	C After -Screw H=5.8	D Before -Screw H=5.8	E .Coalescent Nut H=5.8		
8.Nickel /But back-Shell:Tin						Vacant:Default 1u'	3. 3u'	5. 5u'	6. 10u'	7. 15u'	8. 30u'		
9.Tin													
11.Gold													
1.White													
3.Black													
4.Yellow													
6.Green													
9.Blue						1 Full Gold							
10.PC99						2 Half Gold							

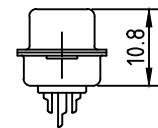
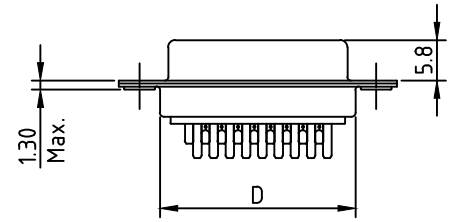

**ELECTRICAL CHARACTERISTICS**

Contact Current Rating: 3Amperes.  
 Dielectric Withstanding Voltage: AC 500V at sea level.  
 Insulation Resistance: 1000Megohms Min.  
 Contact Resistance: 25Milliohms Max.  
 Operation Temperature: -55°C to +105°C.

**Material**

Contact :Copper Alloy.  
 Insulator:PBT. (Select PA6T /LCP /PA9T)  
 Shell: SPCC.  
 Screw: Copper Alloy.

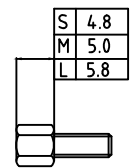

**Note:**

No.	A	B	C	D	E	F
15	16.33	24.99	30.81	19.23	2.29	1.145
26	24.66	33.32	39.14	27.56	2.29	1.145
44	38.38	47.04	53.04	41.28	2.29	1.145
62	54.84	63.50	69.32	57.33	2.41	1.205

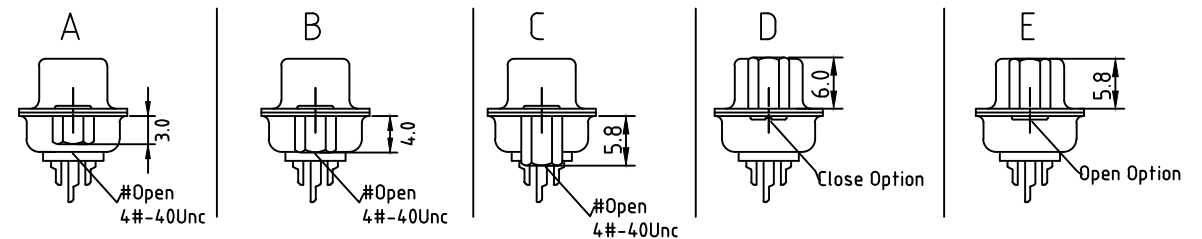

DRAW.BY	LinHaiFong	DATE	2005-10-10	UNIT	MM	TOLERANCE UNSPECIFIED	.X ±0.30 .XX ±0.25 .XXX ±0.150	Ang. ±2°	Chin Shong Enterprise CO., LTD.	ITEM	D-SUB H-D Female Solder
APPVL.BY		VERSION	A	SCALE		DWG.No.	F:/XX/ / +			PART No.	
										CUSTOMER	

1 2 3 4 5 6 7 8